

# ACP-5360

## 5U 20-Slot Rackmount Chassis with 6 Hot-Swap SAS/SATA HDD Trays and Redundant Power Supply

**NEW**

PICMG 1.0

PICMG 1.3



CE FCC RoHS COMPLIANT PRODUCT

### Features

- Supports ATX motherboard, 18-slot PICMG 1.3 express backplane or 20-slot PICMG 1.0 backplane
- Hot-swappable SAS/SATA HDD trays, easy-to-maintain cooling fans and redundant power supply
- System alarm notification LEDs, including system operation, system power, and SAS/SATA storage status
- Front-accessible USB and PS/2 interfaces for easy data transfer
- Lockable front door prevents unauthorized access

### Specifications

Drive Bay	3.5"	Front-accessible
	5.25"	6 SAS/SATA HDDs + 1
	Slim Optical Disk Drive	1
Cooling	Fan	3 (12 cm/114 CFM each) + 2 (8 cm/47 CFM each) for SAS/SATA storage unit
	Blower	2 (25 CFM each) on rear
	Air Filter	Yes
Front I/O Interface	USB	2
	PS/2	1
Miscellaneous	Notification LEDs	Power, HDD, Fan, Temperature and Power voltage status
	Rear Panel	Two 9-pin D-Sub openings
Environment	Temperature	Operating: 0 ~ 40° C (32 ~ 104° F) Non-Operating: -20 ~ 60° C (-4 ~ 140° F)
	Humidity	10 ~ 85% @ 40° C, non-condensing 10 ~ 95% @ 40° C, non-condensing
	Vibration (5 ~ 500 Hz)	1 Grms 2 G
	Shock	10 G (with 11 ms duration, half sine wave) 30 G
	Physical Characteristics	Dimensions (W x H x D) Weight

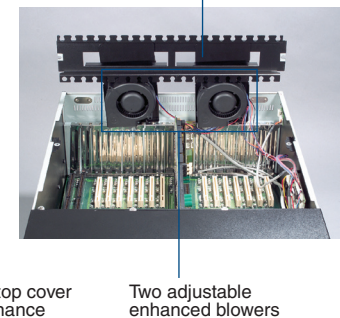
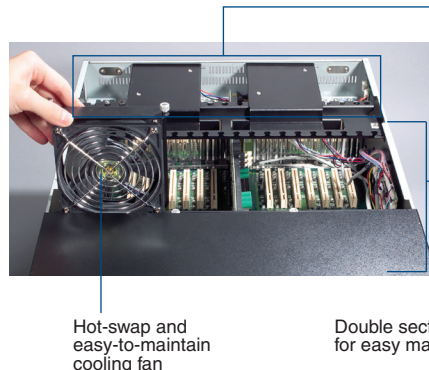
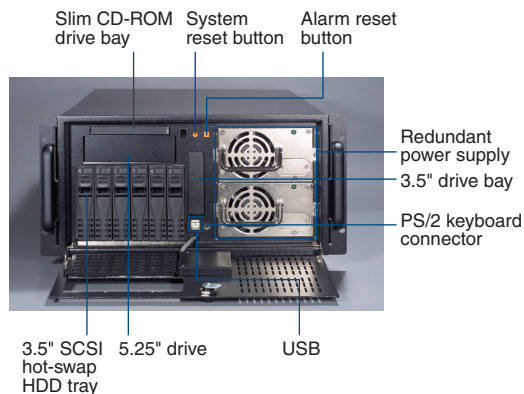

## Dimensions

Unit: mm [inch]

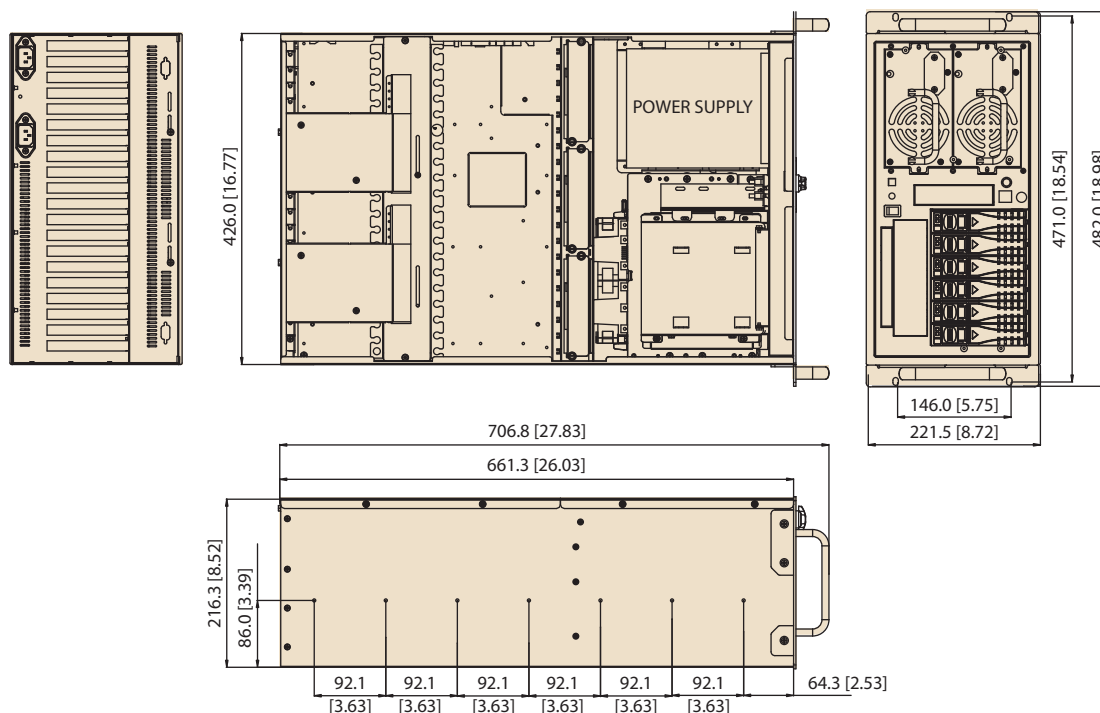

## Ordering Information

Part Number	Power Supply
ACP-5360BP-00RE	Barebone Chassis Supports 460W/ 570W / 810W RPS, with ATX switch
ACP-5360BP-46RE	1757001760

## Power Supply Options

(For detailed power supply specs, please refer to Chapter 7)

Part Number	Specifications	
	Watt	Input
1757001760 (ATX, PFC) (1+1 redundant)	460 W	AC 100 ~ 240 V (full range)
1757001761 (ATX, PFC) (2+1 redundant)	570 W	AC 115 ~ 230 V (full range)
1757001677 (ATX, PFC) (3+1 redundant)	810 W	AC 115 ~ 230 V (full range)

## Optional Accessories

Part Number	Description
9892526000E	Motherboard rear plate kit
2130004797S000	Door filter for power supply 155 x 100 x 5 mm
2130004794S000	Door filter for disk drives 175 x 127 x 5 mm
9662700020E	Black 3.5" mobile HDD tray
2130004798S000	Side filter 107 x 42 x 5 mm
96RC-SAS-4P-PE-LS	Interface PCIe x 8, 4-port SAS/SATA RAID card with 1 SAS SFF8087 connector
96RC-SAS-8P-PE-LS1	Interface PCIe x 8, 8-port SAS/SATA RAID card with 2 SAS SFF8087 connectors
96CB-SAS-SATA-4P	Mini SAS to 4 SATA + SGPIO cable, 0.8 m

PS. When choosing either of above RAID cards, please must use 96CB-SAS-SATA-4P to ensure the LEDs on HDD trays function correctly.